



9 Kerrai Close Lambton NSW

4 2 2

Sitting pretty on 583m² in a quiet cul-de-sac in an exclusive pocket of Lambton is number 9 Kerrai Close. Master built by Huxley Homes this four bedroom brick and tile beauty has been transformed to open up family living spaces and create an entertainers delight. Zoned ducted air conditioning and ceiling fans throughout enhance comfort and the low maintenance yard leaves more time for family and friends.

First impressions will count when you are greeted on first entry with the expansive, open plan lounge, dining, kitchen and living room. Proportions are vast yet intimate with zones defined by well placed furniture leading toward the focal point, a prominent stone island kitchen bench around which family and friends gather.

[For full version visit the website](https://www.reecerealty.com.au)

Type : House
Price : \$1,235,000 - \$1,335,000
Land Size : 583 sqm
View : <https://www.reecerealty.com.au/sale/nsw/newcastle-region/lambton/residential/house/8320023>



Allen Reece
02 4950 2025

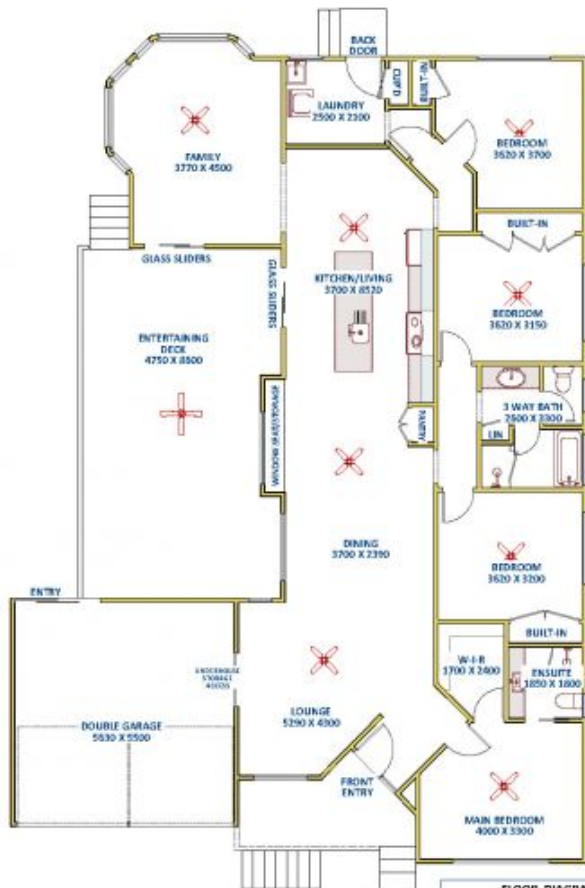

KERRAL CLOSE

Sitemap



FLOOR DIAGRAM **NOT TO SCALE**
 This drawing has been prepared for marketing purposes.
 Dimensions are a guide only.

TOTAL INTERNAL AREA
 APPROX 250127
 B/L GARAGE

9 Kerral Close, LAMBTON