

150 Edith Street Waratah NSW

4 2 1

Centrally located to facilities and services in the desired suburb of Waratah, this 3 bedroom weatherboard & tile home with internally updated 1 bedroom granny flat offers multiple options for home owner or investor. Built circa 1960 it features the larger rooms and high ceilings indicative of the period and is ready for a good refresh to capitalise on its original components. The side drive allowing vehicle access to the rear yard creates further possibilities (STNCC)

Entry from a covered verandah is into the spacious living room off which you will find the master bedroom with wall to ceiling built-in robe, bedroom two, also with built-in robe and a tidy bathroom including separate bath and shower.

Type : House
Price : \$830,000 to \$880,000
Land Size : 468 sqm
View : <https://www.reecerealty.com.au/sale/nsw/newcastle-region/waratah/residential/house/8289623>



Allen Reece
02 4950 2025

[For full version visit the website](https://www.reecerealty.com.au)



FLAT

**TOTAL INTERNAL AREA
APPROX 41M2**

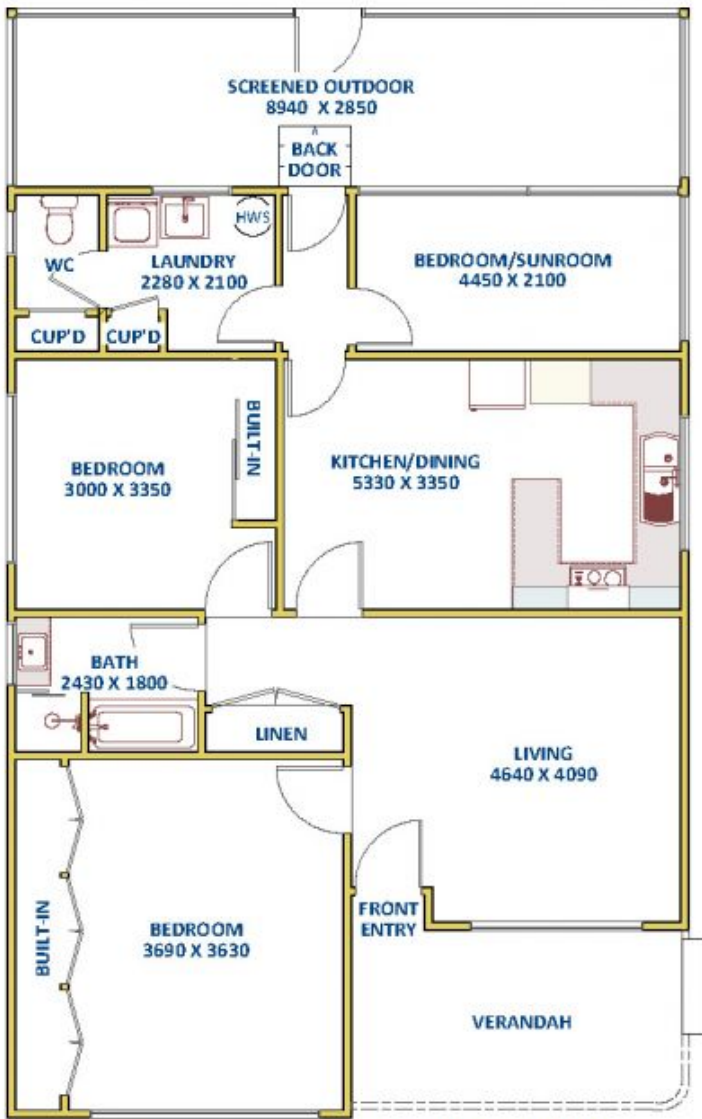

HOUSE

**TOTAL INTERNAL AREA
APPROX 104M2**

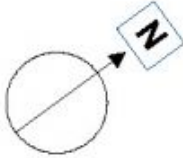

Sitemap



**FLOOR DIAGRAM
NOT TO SCALE**
This drawing has been prepared for marketing purposes. Dimensions are a guide only.

150 Edith Street, WARATAH