



## 32 Lee Crescent Birmingham Gardens NSW

2  1  1 

This modern stunning home is located in an ideal location being a short stroll to Newcastle University, public transport and only minutes away from Jesmond Central Shopping Centre. The property features:

- Two spacious bedrooms, both with built-in robes and plush carpet
- Lounge room and sunroom ideal for a home office or children's play area
- Open plan kitchen/family living with air-conditioning
- Spacious alfresco entertaining deck
- Modern bathroom with large shower, separate w/c
- Single lock up garage

This property is not one to be missed!

[For full version visit the website](https://www.reecerealty.com.au/lease/nsw/newcastle-region/birmingham-gardens/residential/house/7995572)

**Type** : House

**View** : <https://www.reecerealty.com.au/lease/nsw/newcastle-region/birmingham-gardens/residential/house/7995572>



**Lauren Kirk**  
02 4950 2025

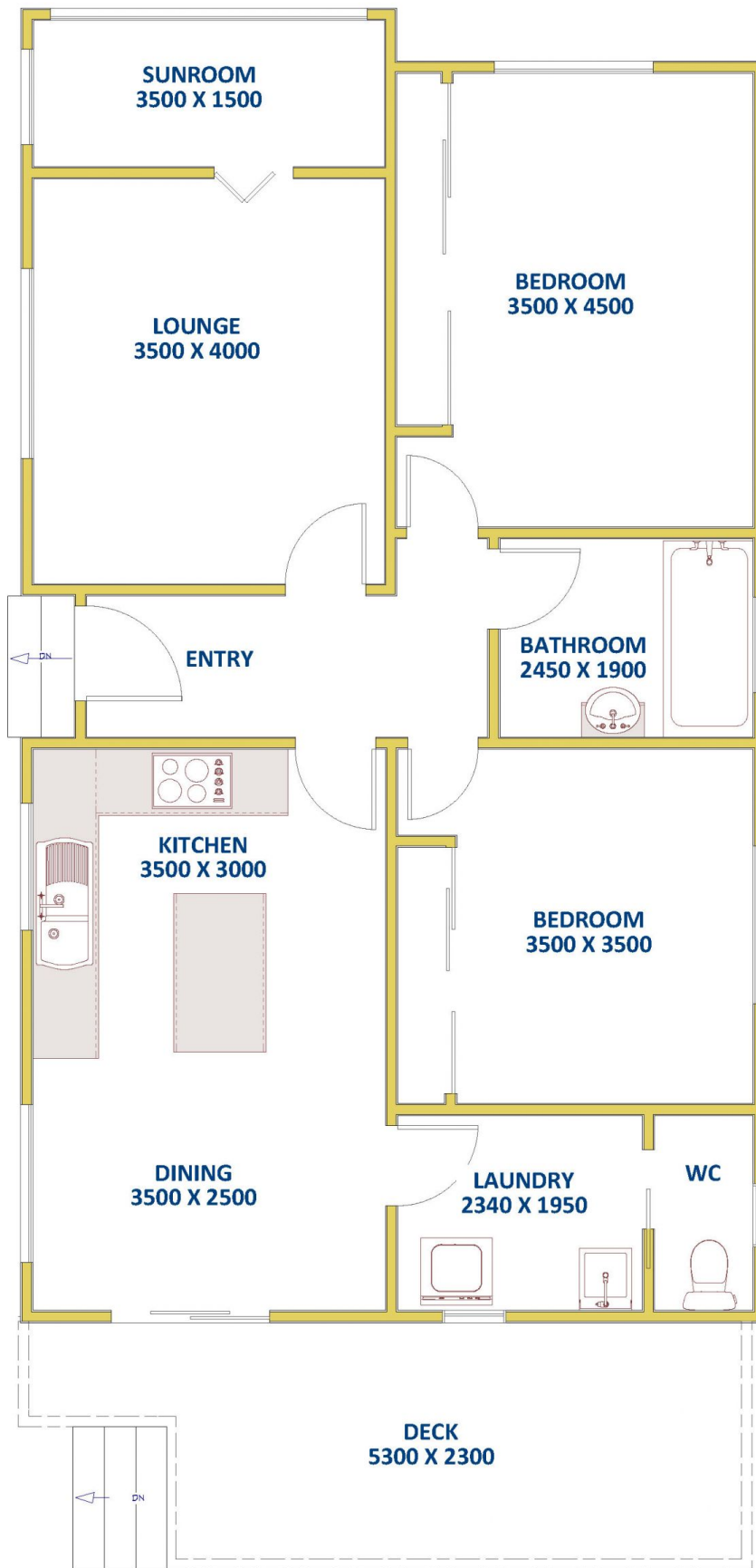

**32 Lee Crescent,  
Birmingham Gardens**

DISCLAIMER: Measurements are approximate for illustration purposes and are to be used only as a guide