



3 Coral Sea Avenue Shortland NSW

3 1 1

Set on a 556m² block in a quiet street of Shortland is this 3 bedroom, weatherboard mid century modern starter with a pleasant northerly facing front verandah. Built by the current owner's father, this loved family home is filled with MCM defining features that maximise space and light and offer design potential for those who appreciate the aesthetic.

The simple, peaked roof line coupled with north facing clerestory windows create a sense of space and light within the modest living areas. Entry is into the living/dining room which leads to the kitchen at the rear or lounge, bedrooms and bathroom to the right. Quaint french doors from the central lounge open onto the front verandah. Here ceiling height is at it's peak.

Enter three good sized bedrooms, one with built-in, or the

Price : \$600,000 to \$640,000
Land Size : 556 sqm
View : <https://www.reecerealty.com.au/sale/nsw/newcastle-region/shortland/residential/house/7988548>



Allen Reece
02 4950 2025

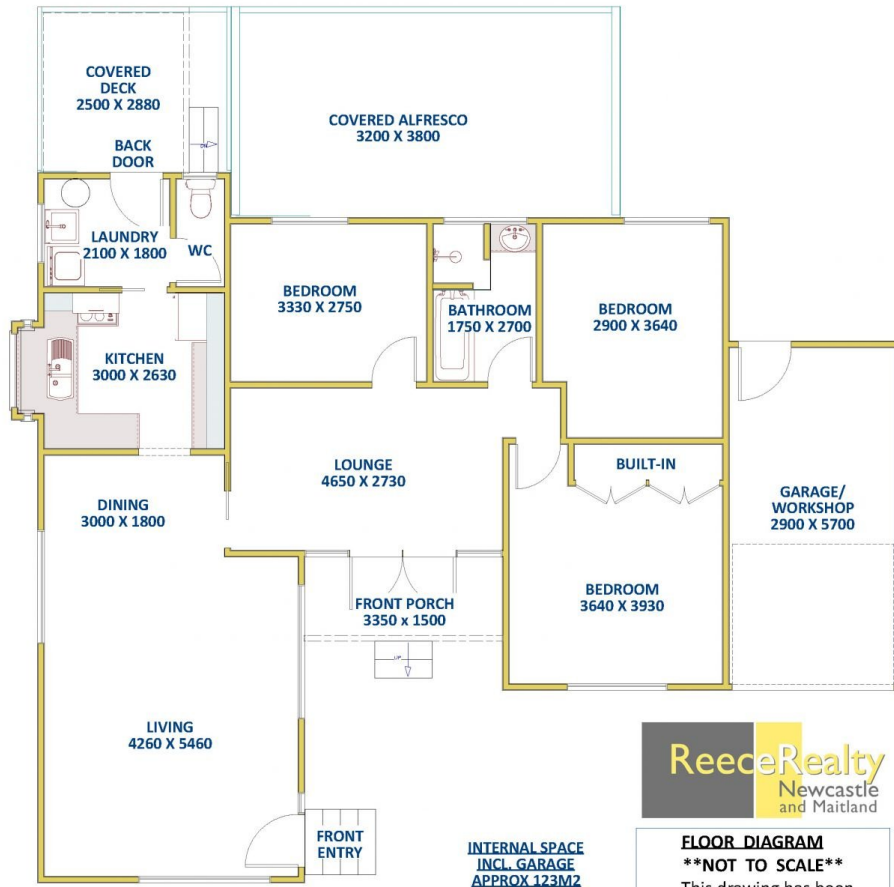

ReeceRealty
Newcastle
and Maitland

FLOOR DIAGRAM

****NOT TO SCALE****

This drawing has been prepared for marketing purposes. Dimensions are a guide only.

INTERNAL SPACE
INCL. GARAGE
APPROX 123M²

3 Coral Sea Avenue, SHORTLAND