

22 Rae Street Birmingham Gardens NSW

6 2 2

Potential plus describes this six bedroom, two bathroom weatherboard and tile dwelling on 689m2 nestled under the shade of two mature trees and with district views from the front porch over the lawn and picket fence. With approximately \$1100 per week return it could be maintained as a high yield student rental or be re imagined as a spacious family home with multiple living areas.

All six bedrooms are a good size, five with ceiling fans and two include built-ins. The two bathrooms have been smartly renovated as two-way, allowing use of the vanity whilst closing off the bathing area. A separate WC adds to convenience for share housing.

A central kitchen includes all necessary fixtures with wall oven, electric cooktop and double sink. The pass through window into a generous dining/living at the rear opens up the space. Egress to the huge covered outdoor entertaining zone and entry to the internal laundry is from the

Land Size : 689 sqm
View : <https://www.reecerealty.com.au/sale/nsw/newcastle-region/birmingham-gardens/residential/house/7899130>



Allen Reece
02 4950 2025

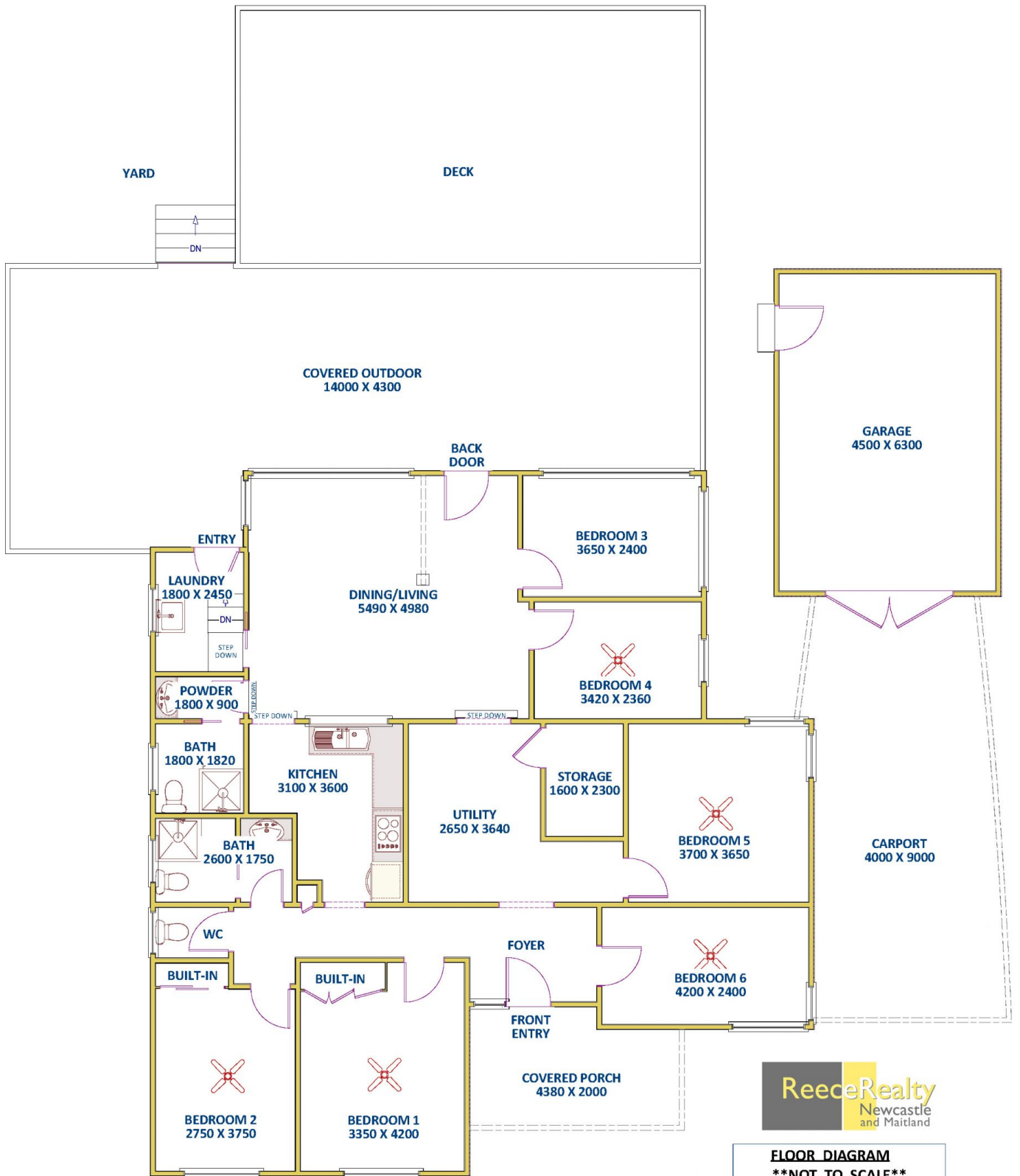

Internal Living Area
approx. 158m²

**22 Rae Street,
BIRMINGHAM GARDENS**

ReeceRealty
Newcastle
and Maitland

FLOOR DIAGRAM
****NOT TO SCALE****
This drawing has been prepared for marketing purposes. Dimensions are a guide only.