



## 9 Andrew Close North Lambton NSW

7 🏠 2 🛏️

Modern well positioned fully furnished student house. Common areas feature open plan lounge/ dining with a modern kitchen. Bedrooms include bed, desk, chair and clothing storage. Internal laundry and off street parking. Within walking distance to Uni, transport and shops.

**Price** : \$280.00 per week

**View** : <https://www.reecerealty.com.au/lease/nsw/newcastle-region/north-lambton/residential/house/7839875>

\*\*\*Sorry no pets\*\*\*

\*\*Note - the room's rent includes electricity and water usage\*\*

Internet is provided at the property as a complimentary utility. It should be noted that its reliability, speed or availability cannot be guaranteed.



**Melissa Reece**  
02 4950 2025

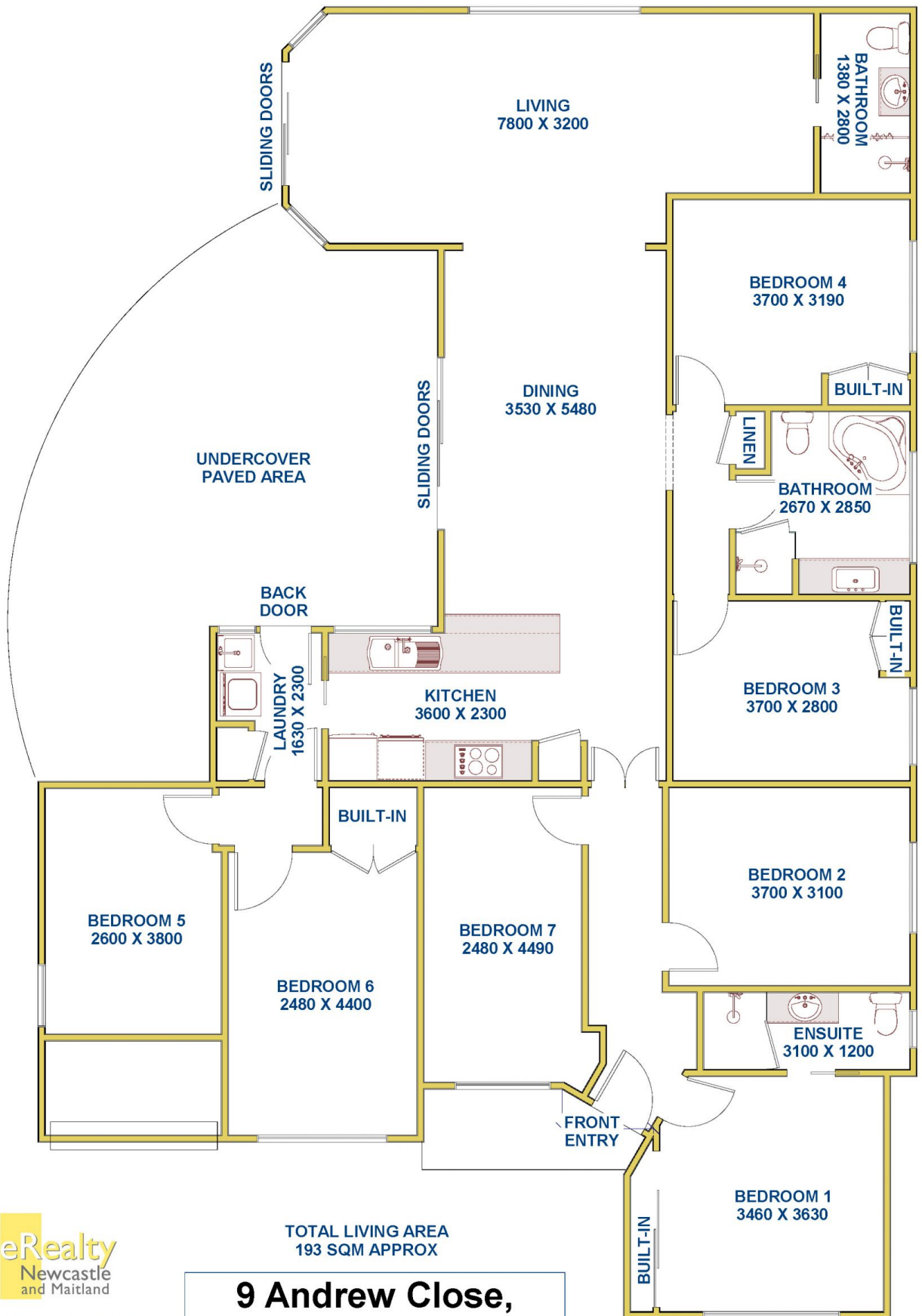

TOTAL LIVING AREA  
193 SQM APPROX

**9 Andrew Close,  
NORTH LAMBTON**



DISCLAIMER: Measurements are approximate for illustration purposes and are to be used only as a guide