



16 Adelaide Street Waratah West NSW

3  1  1 

Lovingly maintained by the same family over many years, this cherished home is on a generous, almost level, 531m2 corner block in a quiet residential street. This clad and tile home is only a short drive to shops, schools and services.

With the dwelling sitting closer to, and garage entry on, the Coronation Street side, this corner block with 27.4m frontage on the Adelaide Street side offers potential for granny flat construction or other possible development opportunities (subject to NCC).

Entry from the front verandah is into a spacious, light filled living room. Walk straight through to the dining area and kitchen or open glass cavity sliding doors into a formal lounge/dining room with reverse cycle air conditioning and ceiling fan. Should a fourth bedroom be required this formal room could easily be converted to suit. Original details can

Price : \$ 735,000
Land Size : 531 sqm
View : <https://www.reecerealty.com.au/sale/nsw/newcastle-region/waratah-west/residential/house/7688750>



Allen Reece
02 4950 2025

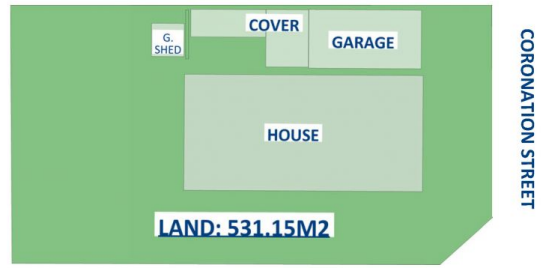

ADELAIDE STREET

CORONATION STREET

LAND: 531.15M2

SITEMAP

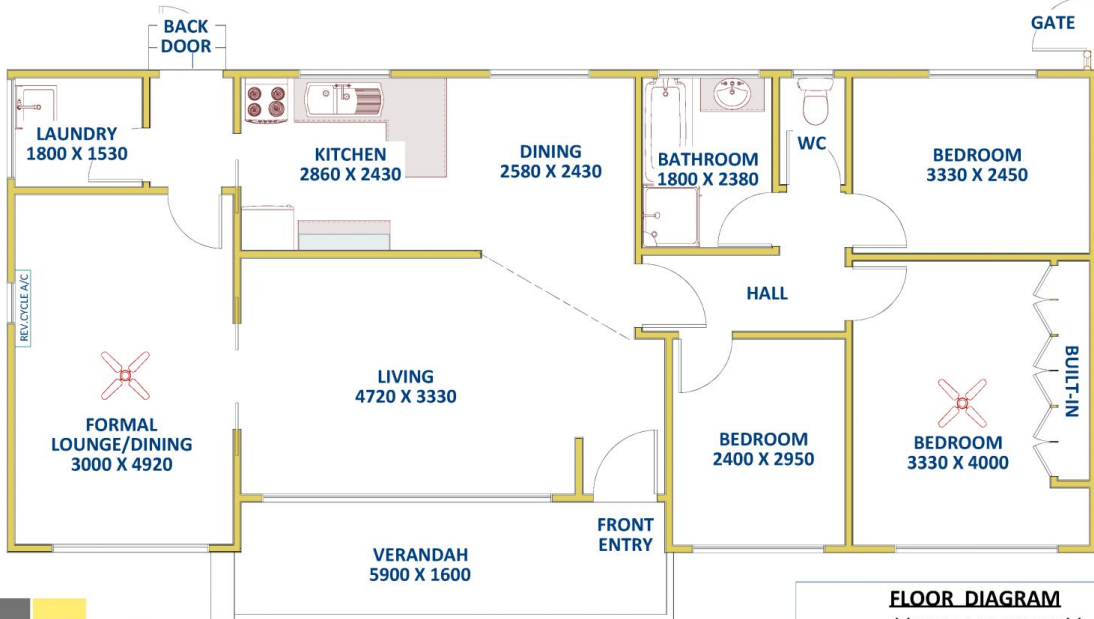
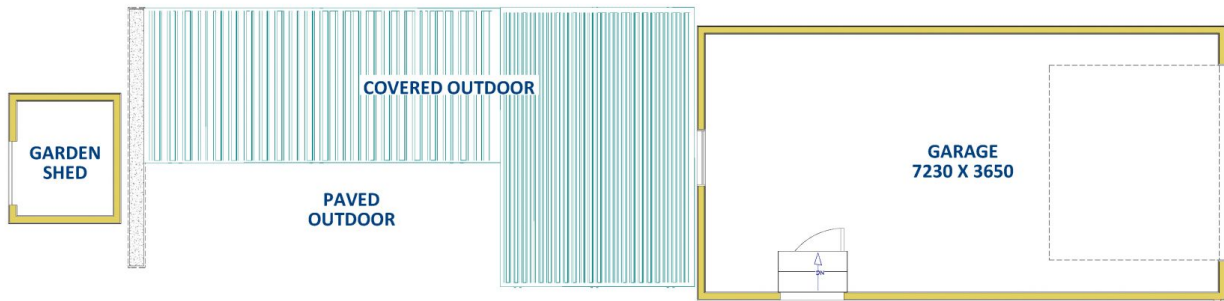

TOTAL LIVING AREA
APPROX 100M2

**FLOOR DIAGRAM
NOT TO SCALE**

This drawing has been prepared for marketing purposes. Dimensions are a guide only.



16 Adelaide Street, WARATAH WEST