



24 Second Avenue North Lambton NSW

3  1  2 

Circa 1950's solid brick and tile home close to University, parkland, shops and only 8km to Newcastle CBD. Sitting with district views in an elevated position on sloping 436m² corner block in sought after suburb.

A range of original architectural features nostalgically resonate, including high ceilings, decorative cornices, bathroom fixtures, light shades and more.

Front entry is from the high set front verandah into a wide hall with bedrooms to the left. All are generous in size with high ceilings & built-in robes. Light filled & spacious, the lounge looks out to the front porch through wall to wall windows. Art Deco cornices and fireplace mantle decorate the space.

A neat & functional kitchen/dining area has updated

Land Size : 436 sqm
View : <https://www.reecerealty.com.au/sale/nsw/newcastle-region/north-lambton/residential/homeuse/7665799>



Allen Reece
02 4950 2025

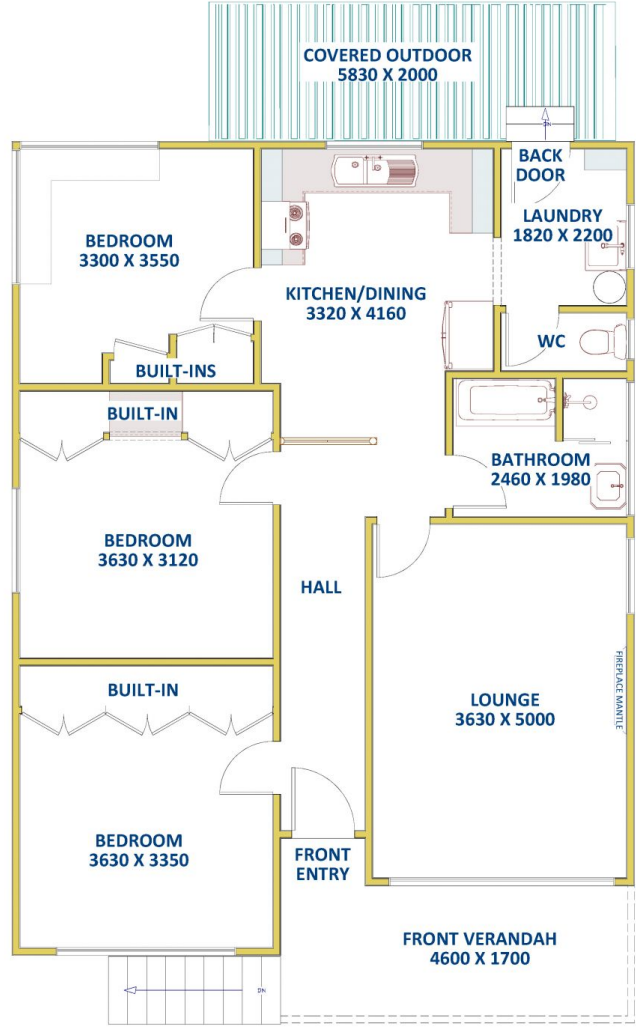
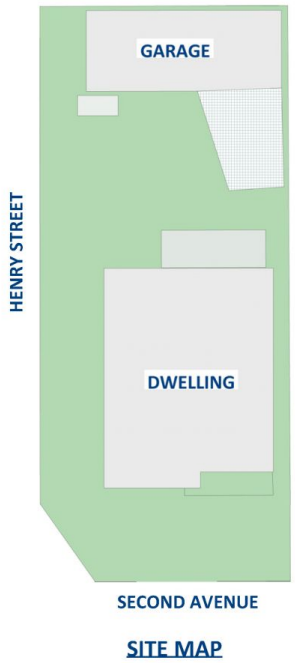
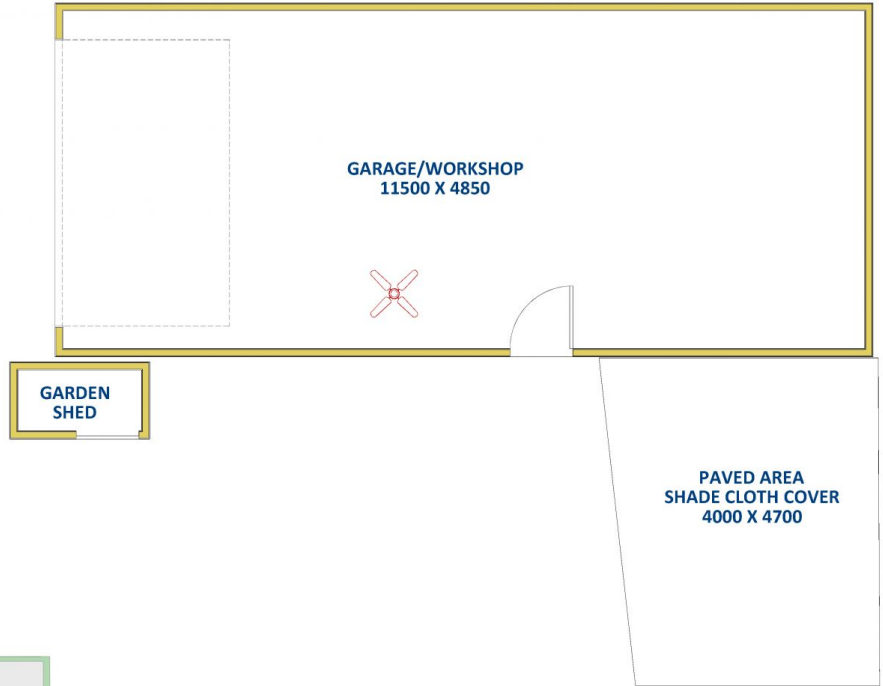

FLOOR DIAGRAM
****NOT TO SCALE****
This drawing has been prepared for marketing purposes. Dimensions are a guide only.

TOTAL LIVING AREA
APPROX 98 M2

24 Second Avenue, NORTH LAMBTON

