



## 608/12 Bellevue Street Newcastle West NSW

2 2 1

Savour harbour views from this north easterly facing, two bedroom, two bathroom apartment on the 6th floor of this luxury security apartment building. Superb location amid the sights and services of Newcastle West & the Honeysuckle precinct. A dedicated parking space adds value however the interchange nearby makes all that Newcastle has to offer easily and quickly accessible.

Open plan living and multiple glass sliding doors through to the spacious balcony fill the unit with light and focus on harbour views. A sleek white kitchen and timber look floors present fresh and timeless appeal. Quality appliances provide convenience and reverse cycle air conditioning offers comfort.

Both bedrooms feature views and floor to ceiling sliding glass door access to the balcony. Your master bedroom includes a walk-in robe and modern ensuite.

**Building Size** : 99 sqm  
**View** : <https://www.reecerealty.com.au/sale/newcastle-region/newcastle-west/residential/unit/7665798>



**Allen Reece**  
02 4950 2025

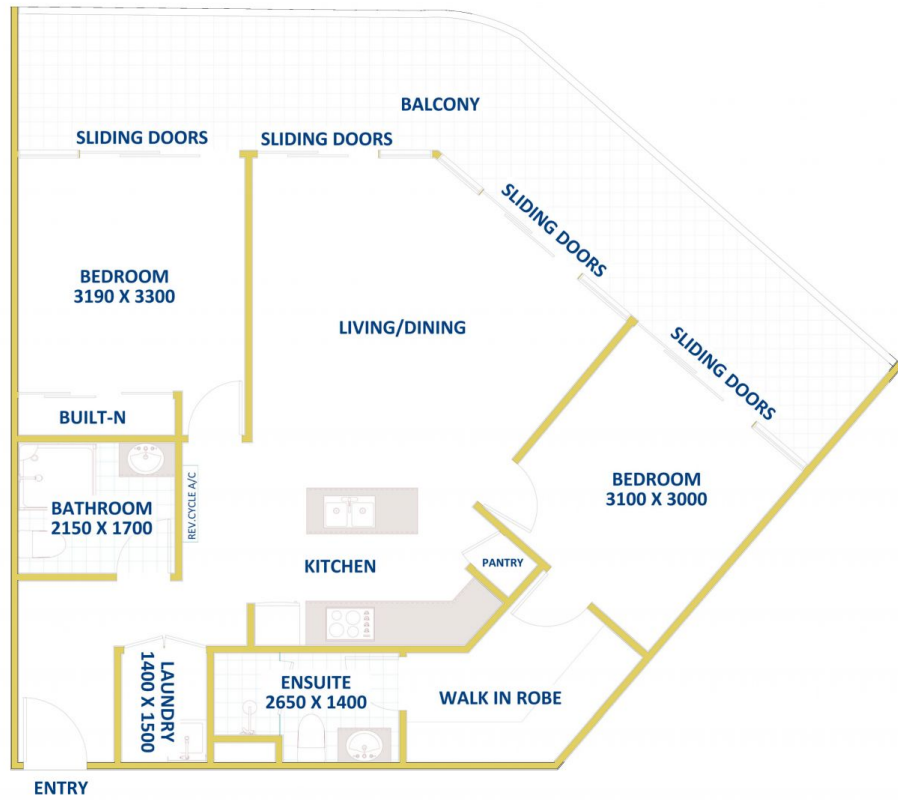

**TOTAL LIVING AREA  
APPROX 99 M2**

**608/12 Bellevue Street,  
NEWCASTLE WEST**

**FLOOR DIAGRAM**

**\*\*NOT TO SCALE\*\***

This drawing has been prepared for marketing purposes.  
Dimensions are a guide only.

**ReeceRealty**  
Newcastle  
and Maitland