



## 30 Bindowan Crescent Maryland NSW

3 1 2

This stylish brick and tile home situated in one of Maryland's main streets is oozing with quality and class.

You make entry into the house via a covered porch. The spacious formal living and dining area features large light filled windows at the front of the house and flows into the separate open plan contemporary kitchen and family room area. The kitchen with an oven & separate grill, ceramic cooktop and plenty of bench space would suit large family entertaining.

There is a third living area in the fully enclosed sunroom that overlooks the large backyard.

The three double sized bedrooms all have built-in robes and are situated in a row down one side of the house with the centrally located bathroom with full size bath and

**Land Size** : 553 sqm  
**View** : <https://www.reecerealty.com.au/lease/nsw/newcastle-region/maryland/residential/house/7629896>



**Nick Majurovski**  
02 4950 2025

Covered  
BBQ area  
1800 x 3500

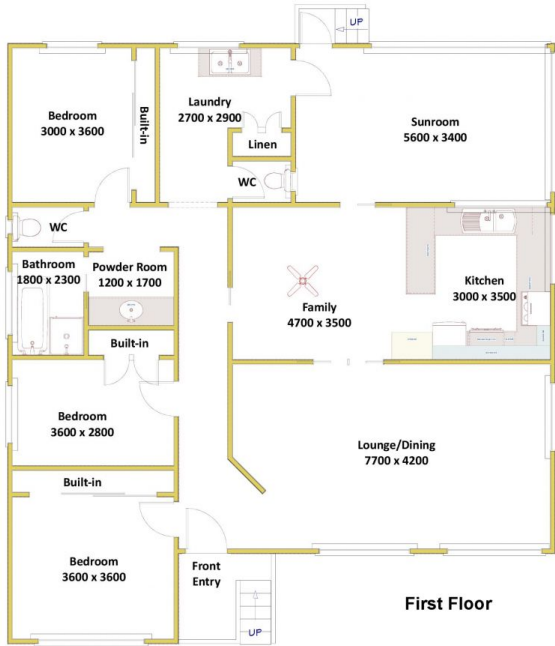

First Floor



Ground Floor

**30 Bindowan Crescent  
MARYLAND**

DISCLAIMER: Measurements are approximate for illustration purposes and are to be used only as a guide

