

24a Ralph Street Jesmond NSW

1  1 

You enter this lovely 1-bedroom granny flat through a private courtyard and walk into a brightly lit, open living space sitting on floating floorboards.

The bedroom has grey carpets with a corner setup, perfect for a unique corner study setup in the bedroom.

The kitchen features open shelving, electric stove cooking and a front loader washing machine.

The contemporary bathroom features a shower and w/c with storage space.

Located on the high side of Jesmond close to the the Shopping Centre, Newcastle University, and public

[For full version visit the website](#)

Type : Unit

View : <https://www.reecerealty.com.au/lease/nsw/newcastle-region/jesmond/residential/unit/7605538>



Melissa Reece
02 4950 2025

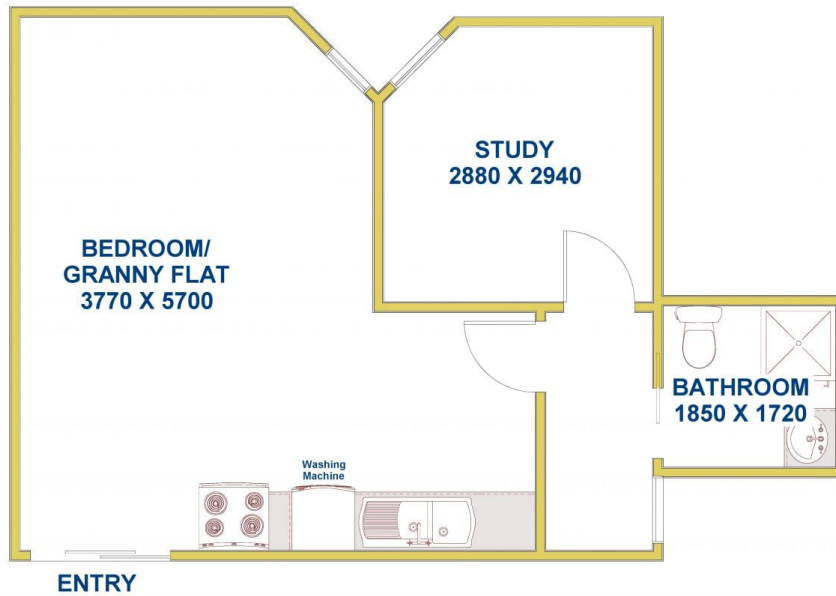

24A Ralph Street, JESMOND

Granny Flat

FLOOR DIAGRAM **NOT TO SCALE**
This drawing has been prepared for marketing purposes. Dimensions are a guide only.