



36 Mary Street Jesmond NSW

Student accommodation house featuring 6 bedrooms, 2 bathrooms with modern furnishings. All bedrooms are of a generous size and equipped with a double bed, student desk, and wardrobe. Excellent position to the Newcastle University and Jesmond shopping centre.

****Rent Includes Electricity, Water - NO CAPPED AMOUNTS****

Internet is provided as a complimentary service

6  2 

Price : \$190per week

View : <https://www.reecerealty.com.au/lease/nsw/newcastle-region/jesmond/residential/house/7425177>



Melissa Reece
02 4950 2025

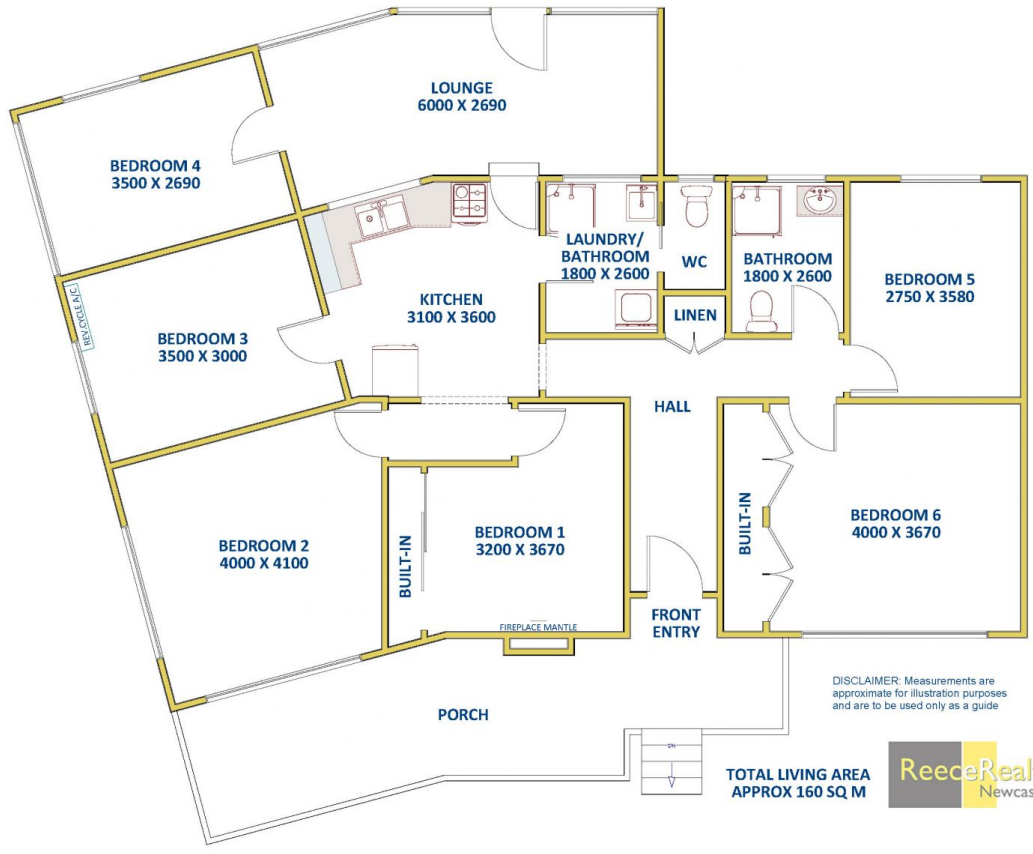

DISCLAIMER: Measurements are approximate for illustration purposes and are to be used only as a guide

TOTAL LIVING AREA APPROX 160 SQ M



36 Mary Street, JESMOND