



50 Heaton Street Jesmond NSW

This student house is in a prime location, with two modern bathrooms, Tidy kitchen and dining area. Each room features bed, desk and student desk chair. Property is located within walking distance to the University of Newcastle and a Stockland shopping centre. On street parking is limited around this property.

** Rent includes Electricity and Water**
Internet is provided as a complimentary service

1 4

Type : House

View : <https://www.reecerealty.com.au/lease/nsw/newcastle-region/jesmond/residential/house/7425135>



Melissa Reece
02 4950 2025

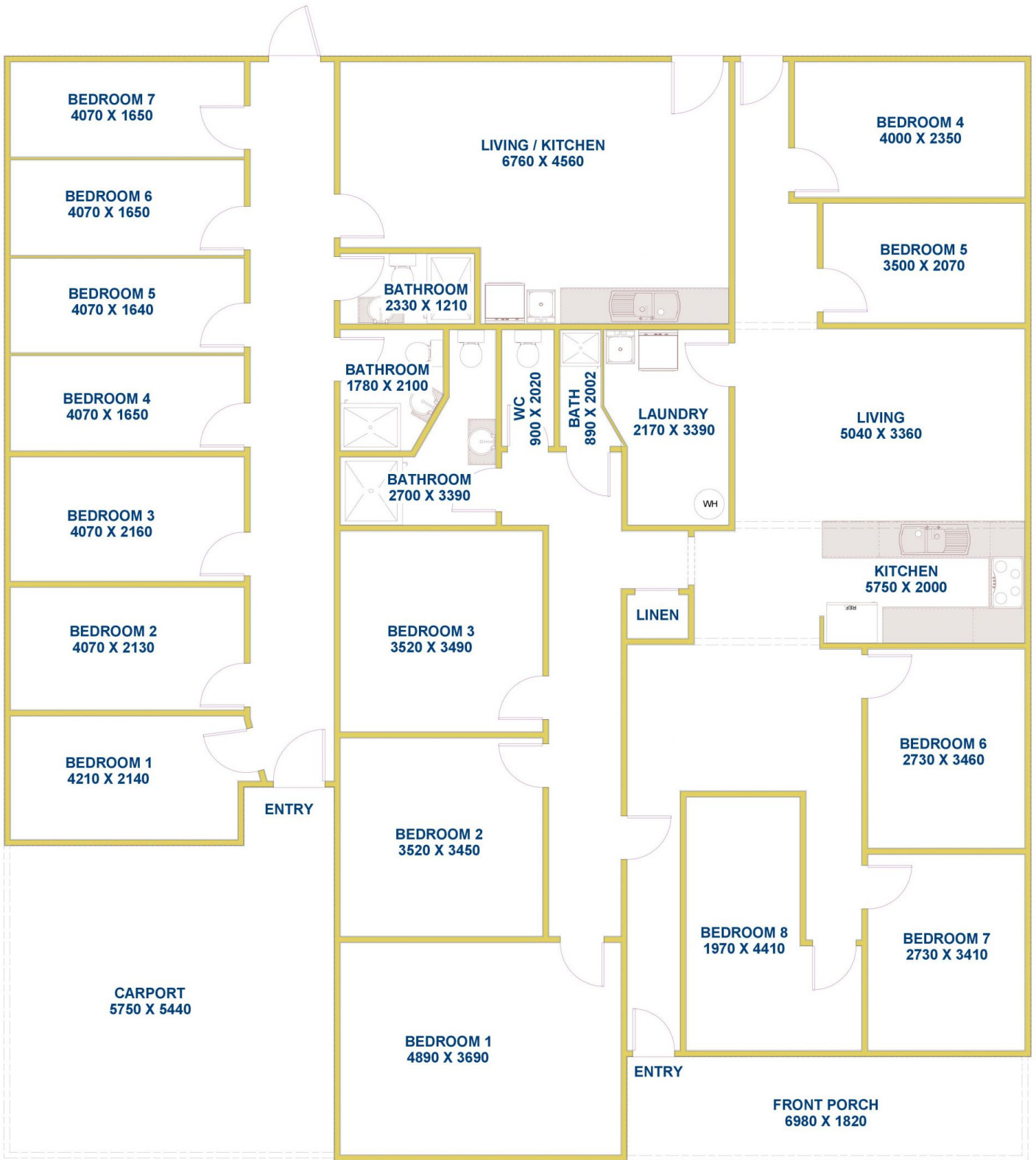

**50A HEATON STREET,
JESMOND**

CURRENT FLOOR PLAN

**** NOT TO SCALE** Visual Diagram Only**

Disclaimer

This drawing has been prepared for marketing purposes only. The information and dimensions are a guide only and have been prepared in good faith and with due care. Reece Realty Newcastle, its employees, agents or representatives will not be liable for any loss or damage resulting from any statement, figure, calculation or any other information that any person or organisation relies upon that is contained in this drawing. If any person or organisation requires verification of the contents of the drawing, we recommend that they arrange a registered surveyor to determine the accuracy of walls, columns, areas and set of the plan.

**50 HEATON STREET,
JESMOND**